

RESOLUTION - 2018-20

**AUTHORIZING APPLICATION FOR
FINANCIAL ASSISTANCE FROM THE RURAL ECONOMIC ACTION PLAN FUND**

WHEREAS, Town of Fairland (Applicant Name) desire to seek funding from the Rural Economic Action Plan Fund for Fairland Volunteer Fire Department (Project Description) in said Town of Fairland ; (Applicant name) and

WHEREAS, it is in the best interest of the residents of Town of Fairland (Applicant name) to expedite the preparation and submission of an application for financial assistance from the Rural Economic Action Plan Fund, in the form of a grant.

NOW, THEREFORE, BE IT RESOLVED that, the Fairland Volunteer Fire Department (Chief Elected/Appointed Official) of the Fairland Volunteer Fire Department (Applicant name) is hereby authorized and directed to sign an application and related documents necessary to file and process a grant application through Grand Gateway EDA's Rural Economic Action Plan Fund on behalf of Fairland Volunteer Fire Department (Applicant name).

PASSED AND APPROVED by the BOCC on
this 2nd day of October, 2018.

By: [Signature]
Chief Elected/Appointed Official

Subscribed and sworn to before me this 2nd day of October, 2018.

ATTEST:

Rebenn Mitchell

Clerk/ Notary Public

My Commission Expires: _____

(Seal)



South east of fairland

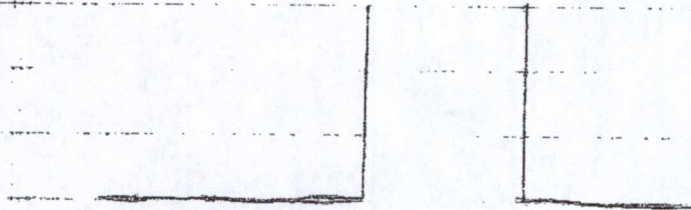

South 600 Rd

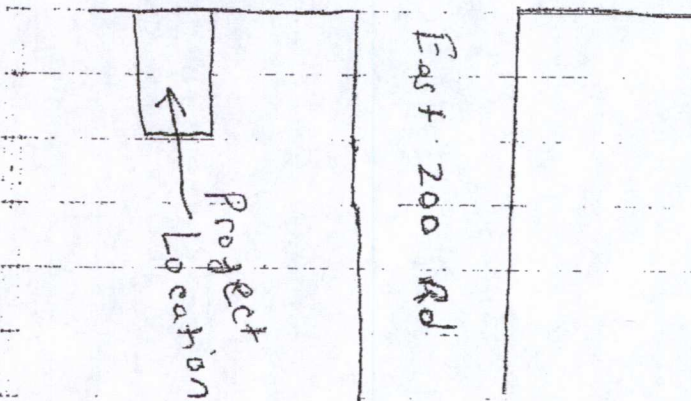

Fairland Volunteer Fire Department

P.O. Box 911

Fairland, OK 74343

Non-Emergency Phone: 918-676-5168

September 24, 2018

To whom it may concern:

The Fairland Volunteer Fire Dept. has just completed a new station in the rural area. This station, along with our other two stations, will put most citizens within 5 miles of fire services and will also help reduce their insurance cost.

We will be putting an engine in that station and would like to purchase a new grass truck to place there also. We are looking at a one ton cab and chassis that we can put a bed and a skid unit on. Between Ford and Dodge we are looking at approximately \$42,000.00 to \$46,000.00 cost for the truck. A skid unit will be between \$10,000.00 to \$12,000.00. Having another grass truck in the county will allow us quicker response time to grass and timber fires and also give more resources for helping with surrounding towns and fire departments.

We are acquiring donations and membership fees that will be added to any grant money received to finish the needed funding.

Thank you for your help in the past and your consideration in this REAP Grant.

Sincerely,

Mike Goins

Asst. Fire Chief

MEMORANDUM

TO: Rural Economic Action Plan (REAP) Eligible Entities
FROM: Annette Morgan, REAP Director, GGEDA
DATE: August 2019
SUBJECT: FY '19 REAP Application and Attachments

Enclosed you will find the FY '19 REAP Application. The deadline for submitting completed REAP applications is October 4, 2018. REAP Funds will be contingent upon State Funding.

No applications will be accepted after 4:30 p.m. on October 4, 2018.

The FY '19 application is one page, but please note that three attachments (a resolution, a map of the project area, and a project budget) must be submitted.

Note: Eligible entities are governmental entities such as counties and municipalities. Rural fire districts, rural water and/or sewer districts, schools and other entities may also apply but must obtain sponsorship by the county or municipality in which they are located.

Only one application may be submitted for each municipality.

Counties can submit an application for each district and may sponsor an unlimited number of applications.

Police and fire departments that fall under the umbrella of a municipality must apply through the municipality.

If the application is for construction, the building and land for the planned construction must be owned by a municipality or county.

Projects that benefit over 7,000 citizens are not eligible for REAP funding.

Ineligible Projects during the 2019-2020 REAP cycle include but are not limited to consumable goods and office supplies, personnel costs, park projects, fairgrounds projects, mowers and lawn maintenance equipment, veteran's memorials, Capital Improvement Plans, Comprehensive Plans, Housing projects, and County Maintenance Barns for county commission districts with a population of more than 7000 or greater.

Requirements: Entities submitting a REAP application must have their GGEDA dues current as of September 2018, if dues are not current points based on requests will be deducted.

**** FY-19 REAP Application questions must be filled out in its entirety.
DO NOT use "SEE ATTACHED" or "N/A" ****

Completed applications should be mailed to:

**Grand Gateway EDA
Attn: Annette Morgan
REAP Director
P.O. Drawer B
Big Cabin, OK 74332**

Applications may also be delivered in person to our offices in Big Cabin, Oklahoma.

GGEDA's offices are located at 333 S. Oak Street, in the former Big Cabin school building, three blocks south of Main Street. Office hours are Monday through Thursday, 7:30 a.m. until 5:30 p.m.

Questions about the application may be directed to Annette Morgan at @ 1-800-482-4594 ext. 216.

REAP '19 APPLICATION INSTRUCTIONS

I. **APPLICANT INFORMATION :** A - C are self explanatory, but it is very important that a contact person be provided, along with a telephone number in case there are any questions about your application.

II. PROJECT INFORMATION

- A. Project type - When judging the project, determine whether it will improve the community or economy of your area or whether it is a transportation project. If it creates jobs or brings a business into your area, it would be an economic project. If it improves the quality of life for your area, it will be a community project. If it is a re-paving project for a road, it will be transportation, but if a road project helps create permanent jobs or brings a business to your community, it could be an economic project as well.
- B. Project location - a map must be enclosed with the application. It can be hand drawn, an Internet map or copied from a road map. Nothing fancy is necessary. *Please highlight your project area.*
- C. Amount of grant request - this is the amount you need from Grand Gateway EDA to complete the project. You may request up to \$50,000.
- D. Total number of people benefiting from project - This can be the population of the city, town, or county per the 2000 census. Water districts can use the total number of persons using their service, schools can use the total number of students enrolled, rural fire departments use the number of subscribers, etc.
- E. Project budget - please provide a detailed budget. All costs need to be listed; this should include volunteer labor, donations, and city, town, or county employees who will be used to complete the project.
- F. Amount of matching funds - If there are matching funds for the project, please list all amounts and their sources.
- G. Brief explanation of your local effort in this project - please tell us what the community will do to help complete the project. Explain activities that have produced donations, volunteer labor that can be dedicated to the project, or groups or committees that have been formed and their roles in assisting the project.
- H. Project description - a brief description of the project must be included. Tell us what you want to do and why. For example; 333' of 12" PVC Sewer Line between Peaches & Cream Streets and 4 cell treatment facility.
- I. In order for a project to be eligible for funding, the property must either be owned by the local government submitting the application, or the local government submitting the application must have a long-term lease on the property.
- J. Does the project create jobs? - Please provide information about any permanent jobs that will be created or saved if the project is funded.
- K. State Senate District # and State Representative District # - provide the state senate and representative district designation number where the project is located. Area legislators and their District numbers are listed here for your convenience:

Senator JJ Dossett	34
Senator Julie Daniels	29
Senator Kim David	18
Senator Michael Bergstrom	1
Senator Marty Quinn	2

Representative William Fourkiller	86
Representative Terry O'Donnell	23
Representative Chuck Hoskin	6
Representative Josh West	5
Representative Mark Lepak	9
Representative Dale Derby	74
Representative Tom Gann	8
Representative Ben Loring	7
Representative Travis Dunlap	10
Representative Earl Sears	11

MAKE SURE AN AUTHORIZED REPRESENTATIVE SIGNS AND DATES THE APPLICATION FORM.

Attachments that must be included with the application

- Resolution - This document must be included. A sample resolution has been provided in the application package. The areas indicated by a parenthesis () should be filled in with the appropriate information (see the sample form). Please retype, providing the appropriate information, have your governing Board adopt the document at a regular or special meeting, and have an authorized representative sign it. Have a notary public or clerk attest it and seal the document with a government or notary seal.
- Map of project area - The map must be included and should be no larger than 8½" x 11".
- Project budget - A detailed line item budget must be included with your application.

GRAND GATEWAY ECONOMIC DEVELOPMENT ASSOCIATION
(GGEDA)

RURAL ECONOMIC ACTION PLAN FY-19
Application # _____
GRAND GATEWAY ECONOMIC DEVELOPMENT ASSOCIATION

I. APPLICANT INFORMATION

- A. Name: Fairland Vol. Fire Dept / Ottawa County Commission County: Ottawa
B. Address: P.O. Box 911 Fairland, OK 74343 Phone: 918-961-0939
Fax: 918-848-5006
C. Contact Person(s) Mike Goins Phone: _____
Email: mgoins2013@yahoo.com

II. PROJECT INFORMATION

(Please fill in each line below with the information requested – (DO NOT USE "SEE ATTACHED" or "N/A")

- A. Project Type: Economic/Community Development _____ Transportation X
B. Project Location (Attach Map) _____
C. Amount of Grant Request (Maximum \$50,000): \$ 50,000.00
D. Total number of people benefiting from project: 2000
E. Project Budget (Must be attached) _____
F. Explanation of matching funds: Taking donation and membership, monies that are required. \$8,000.00
G. Brief explanation of local effort in project: Having new equipment to respond to emergencies with decreased time for safety.
(Attach additional sheets if needed)
H. Brief description of the project: (Attach additional sheets if needed) Fire Truck \$46,000.00 skid unit and bed to put on fire truck to make one unit
I. If construction project, who owns the property on which the project will be constructed? Fairland Fire Department \$10,000.00 to \$12,000.00
J. Does the project create jobs? Yes _____ No X
K. State Senate District #: 1 State Representative District #: 7
L. How much of the requested funds will be used for professional consultants (engineers, architects, etc.)? 0

Signature of Authorized Representative _____

Date _____

Mail inquiries to: GGEDA, Attn: REAP, P.O. Drawer B, Big Cabin, OK. 74332. Or call: 1-800-482-4594